



Woodbury County Conservation Dept.

4500 Sioux River Road, Sioux City, Iowa 51109
Phone: 712-258-0838
www.woodburyparks.org



Area Information

Acres: 2
Usage: Fishing Access, Historic Information
Contact: Southwood Conservation Area
3399 330th St., Smithland, IA 51056
712-889-2215

Inkpaduta Historical Marker

310th Street

To Smithland

Woodbury County, Iowa

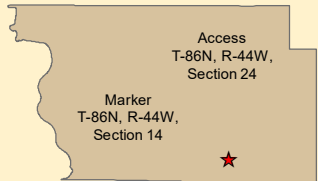

Directions: Marker - 2 miles N of Smithland on Hwy 31. Access - then 1 mile E on 310th Street.

Legend

- Inkpaduta Historical Marker
- Inkpaduta Access

Inkpaduta Access/ Inkpaduta Historical Marker



Aerial Photo - Summer, 2010
Map Creation Date: 1/2011

Disclaimer: Information and boundaries depicted on this map have been carefully reviewed. However, this data is not guaranteed to be free of errors or inaccuracies as provided by Woodbury County or other providers and sources of data contained in this map. Boundary signs have been placed on our areas to ensure users do not trespass on private property.